

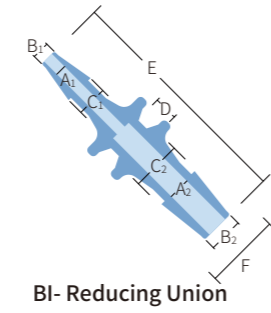

Barbed Union

Features:

- Plug-in hose connectors for easy and convenient application
- Anti-slip and catch-edge design for no leakage
- Imported raw material, non-toxic, tasteless, heat and corrosion resistant
- PP material is widely used in biomedical, environmental protection and food industries

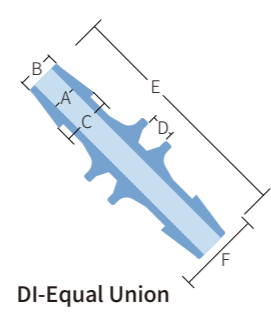
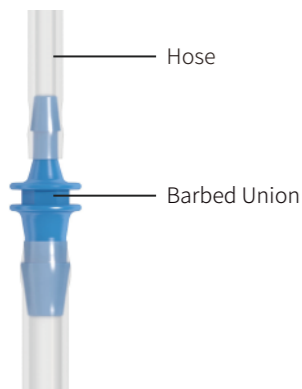

Unit: mm

Model No.	Tubing ID	Dimension (mm)						Material
Equal Union								
DI-016	1.0~1.6 mm	A=Φ0.99	B=Φ1.60	C=Φ2.80	D=2.0	E=18	F=Φ7	PP natural
DI-024	1.6~2.4 mm	A=Φ1.58	B=Φ2.40	C=Φ3.40	D=2.0	E=20	F=Φ7	PP natural
DI-032	2.4~3.2 mm	A=Φ1.97	B=Φ3.20	C=Φ4.20	D=2.0	E=20	F=Φ7	PP natural
DI-040	3.2~4.0 mm	A=Φ2.46	B=Φ4.00	C=Φ6.00	D=2.5	E=33.2	F=Φ10	PP natural
DI-048	4.0~4.8 mm	A=Φ2.96	B=Φ4.80	C=Φ6.80	D=1.8	E=33.2	F=Φ10	PP natural
DI-064	4.8~6.4 mm	A=Φ4.93	B=Φ6.40	C=Φ8.40	D=3.0	E=40	F=Φ14	PP natural
DI-087	6.4~8.7 mm	A=Φ6.40	B=Φ8.70	C=Φ10.70	D=3.0	E=40	F=Φ14	PP natural
Reducing Union								
BI-016/024	(1.0~1.6) / (1.6~2.4) mm	A ₁ =Φ0.99 A ₂ =Φ1.70	B ₁ =Φ1.60 B ₂ =Φ2.40	C ₁ =Φ2.80 C ₂ =Φ3.40	D=2.0	E=19.5	F=Φ7	PP natural
BI-016/032	(1.0~1.6) / (2.4~3.2) mm	A ₁ =Φ0.99 A ₂ =Φ1.97	B ₁ =Φ1.60 B ₂ =Φ3.20	C ₁ =Φ2.80 C ₂ =Φ4.20	D=2.0	E=21.5	F=Φ7	PP natural
BI-024/032	(1.6~2.4) / (2.4~3.2) mm	A ₁ =Φ1.58 A ₂ =Φ1.97	B ₁ =Φ2.40 B ₂ =Φ3.20	C ₁ =Φ3.40 C ₂ =Φ4.20	D=2.0	E=21.5	F=Φ7	PP natural
BI-024/040	(1.6~2.4) / (3.2~4.0) mm	A ₁ =Φ1.58 A ₂ =Φ2.46	B ₁ =Φ2.40 B ₂ =Φ4.00	C ₁ =Φ3.40 C ₂ =Φ6.00	D=2.0	E=27.9	F=Φ7	PP natural
BI-032/040	(2.4~3.2) / (3.2~4.0) mm	A ₁ =Φ1.97 A ₂ =Φ2.46	B ₁ =Φ3.20 B ₂ =Φ4.00	C ₁ =Φ4.20 C ₂ =Φ6.00	D=2.0	E=28.9	F=Φ10	PP natural
BI-032/048	(2.4~3.2) / (4.0~4.8) mm	A ₁ =Φ1.97 A ₂ =Φ3.45	B ₁ =Φ3.20 B ₂ =Φ4.80	C ₁ =Φ4.20 C ₂ =Φ6.80	D=2.0	E=30.7	F=Φ10	PP natural
BI-040/048	(3.2~4.0) / (4.0~4.8) mm	A ₁ =Φ2.96 A ₂ =Φ3.45	B ₁ =Φ4.00 B ₂ =Φ4.80	C ₁ =Φ6.00 C ₂ =Φ6.80	D=2.0	E=33.1	F=Φ10	PP natural
BI-040/064	(3.2~4.0) / (4.8~6.4) mm	A ₁ =Φ2.96 A ₂ =Φ5.42	B ₁ =Φ4.00 B ₂ =Φ6.35	C ₁ =Φ6.00 C ₂ =Φ8.35	D=2.5	E=36.75	F=Φ14	PP natural
BI-048/064	(4.0~4.8) / (4.8~6.4) mm	A ₁ =Φ3.94 A ₂ =Φ5.42	B ₁ =Φ4.80 B ₂ =Φ6.35	C ₁ =Φ6.80 C ₂ =Φ8.35	D=2.5	E=36.85	F=Φ14	PP natural
BI-048/087	(4.0~4.8) / (6.4~8.7) mm	A ₁ =Φ3.45 A ₂ =Φ6.90	B ₁ =Φ4.80 B ₂ =Φ8.70	C ₁ =Φ6.80 C ₂ =Φ10.70	D=2.5	E=36.85	F=Φ14	PP natural
BI-064/087	(4.8~6.4) / (6.4~8.7) mm	A ₁ =Φ4.93 A ₂ =Φ6.90	B ₁ =Φ6.35 B ₂ =Φ8.70	C ₁ =Φ8.35 C ₂ =Φ10.70	D=2.5	E=40	F=Φ14	PP natural



Elbow Barbed Connector

Features:

- Plug-in hose connectors for easy and convenient application
- Anti-slip and catch-edge design for no leakage
- Imported raw material, non-toxic, tasteless, heat and corrosion resistant
- PP material is widely used in biomedical, environmental protection and food industries

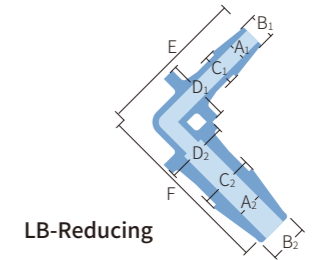
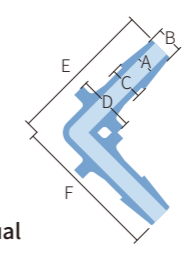
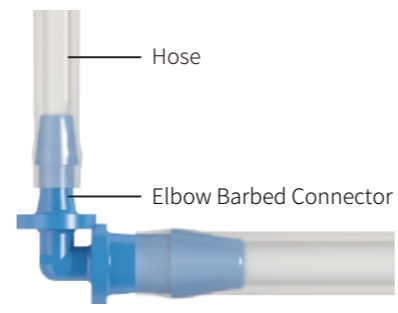

Unit: mm

Model No.	Tubing ID	Dimension (mm)						Material
Equal								
LD-016	1.0~1.6 mm	A=Φ0.79	B=Φ1.60	C=Φ2.80	D=Φ5	E=14.9	F=14.9	PP natural
LD-024	1.6~2.4 mm	A=Φ1.58	B=Φ2.40	C=Φ3.60	D=Φ5	E=14.7	F=14.7	PP natural
LD-032	2.4~3.2 mm	A=Φ1.97	B=Φ3.20	C=Φ4.20	D=Φ7	E=18	F=18	PP natural
LD-040	3.2~4.0 mm	A=Φ2.46	B=Φ4.00	C=Φ6.00	D=Φ8	E=22.9	F=22.9	PP natural
LD-048	4.0~4.8 mm	A=Φ2.96	B=Φ4.80	C=Φ6.80	D=Φ9	E=23.9	F=23.9	PP natural
LD-064	4.8~6.4 mm	A=Φ4.93	B=Φ6.40	C=Φ8.40	D=Φ12	E=32.5	F=32.5	PP natural
LD-087	6.4~8.7 mm	A=Φ6.40	B=Φ8.70	C=Φ10.70	D=Φ14	E=33.8	F=35	PP natural
LD-095	8.7~9.5 mm	A=Φ7.39	B=Φ9.50	C=Φ11.50	D=Φ15	E=38	F=38	PP natural
Reducing								
LB-016/024	(1.0~1.6) / (1.6~2.4) mm	A ₁ =Φ0.79 A ₂ =Φ1.58	B ₁ =Φ1.60 B ₂ =Φ2.40	C ₁ =Φ2.80 C ₂ =Φ3.60	D ₁ =Φ5 D ₂ =Φ5.5	E=14.7	F=14.9	PP natural
LB-016/032	(1.0~1.6) / (2.4~3.2) mm	A ₁ =Φ0.79 A ₂ =Φ1.97	B ₁ =Φ1.60 B ₂ =Φ3.20	C ₁ =Φ2.80 C ₂ =Φ4.20	D ₁ =Φ5 D ₂ =Φ5	E=14.7	F=15.7	PP natural
LB-024/032	(1.6~2.4) / (2.4~3.2) mm	A ₁ =Φ1.58 A ₂ =Φ1.97	B ₁ =Φ2.40 B ₂ =Φ3.20	C ₁ =Φ3.60 C ₂ =Φ4.20	D ₁ =Φ5 D ₂ =Φ6	E=15.7	F=16.7	PP natural
LB-024/040	(1.6~2.4) / (3.2~4.0) mm	A ₁ =Φ1.58 A ₂ =Φ2.46	B ₁ =Φ2.40 B ₂ =Φ4.00	C ₁ =Φ3.60 C ₂ =Φ6.00	D ₁ =Φ6 D ₂ =Φ6	E=15.7	F=20.6	PP natural
LB-032/040	(2.4~3.2) / (3.2~4.0) mm	A ₁ =Φ1.97 A ₂ =Φ2.46	B ₁ =Φ3.20 B ₂ =Φ4.00	C ₁ =Φ4.20 C ₂ =Φ6.00	D ₁ =Φ7 D ₂ =Φ7	E=18	F=21.9	PP natural
LB-032/048	(2.4~3.2) / (4.0~4.8) mm	A ₁ =Φ1.97 A ₂ =Φ2.96	B ₁ =Φ3.20 B ₂ =Φ4.80	C ₁ =Φ4.20 C ₂ =Φ6.80	D ₁ =Φ8 D ₂ =Φ8	E=19	F=22.9	PP natural
LB-040/048	(3.2~4.0) / (4.0~4.8) mm	A ₁ =Φ2.46 A ₂ =Φ2.96	B ₁ =Φ4.00 B ₂ =Φ4.80	C ₁ =Φ6.00 C ₂ =Φ6.80	D ₁ =Φ8 D ₂ =Φ8	E=22.9	F=22.9	PP natural
LB-040/064	(3.2~4.0) / (4.8~6.4) mm	A ₁ =Φ2.46 A ₂ =Φ4.93	B ₁ =Φ4.00 B ₂ =Φ6.40	C ₁ =Φ6.00 C ₂ =Φ8.40	D ₁ =Φ10 D ₂ =Φ10	E=24.9	F=31	PP natural
LB-048/064	(4.0~4.8) / (4.8~6.4) mm	A ₁ =Φ2.96 A ₂ =Φ4.93	B ₁ =Φ4.80 B ₂ =Φ6.40	C ₁ =Φ6.80 C ₂ =Φ8.40	D ₁ =Φ12 D ₂ =Φ12	E=26.9	F=33	PP natural
LB-048/087	(4.0~4.8) / (6.4~8.7) mm	A ₁ =Φ2.96 A ₂ =Φ6.40	B ₁ =Φ4.80 B ₂ =Φ8.70	C ₁ =Φ6.80 C ₂ =Φ10.70	D ₁ =Φ12 D ₂ =Φ12	E=26.9	F=33	PP natural
LB-064/087	(4.8~6.4) / (6.4~8.7) mm	A ₁ =Φ4.93 A ₂ =Φ6.40	B ₁ =Φ6.40 B ₂ =Φ8.70	C ₁ =Φ8.40 C ₂ =Φ10.70	D ₁ =Φ15 D ₂ =Φ15	E=35.5	F=36	PP natural
LB-064/095	(4.8~6.4) / (8.7~9.5) mm	A ₁ =Φ4.93 A ₂ =Φ7.39	B ₁ =Φ6.40 B ₂ =Φ9.50	C ₁ =Φ8.40 C ₂ =Φ11.50	D ₁ =Φ15 D ₂ =Φ15	E=35.5	F=38	PP natural
LB-087/095	(6.4~8.7) / (8.7~9.5) mm	A ₁ =Φ6.40 A ₂ =Φ7.39	B ₁ =Φ8.70 B ₂ =Φ9.50	C ₁ =Φ10.70 C ₂ =Φ11.50	D ₁ =Φ14 D ₂ =Φ14	E=35	F=37	PP natural

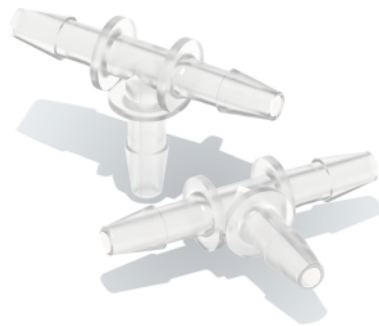

T Barbed Connector

Features:

- Plug-in hose connectors for easy and convenient application
- Anti-slip and catch-edge design for no leakage
- Imported raw material, non-toxic, tasteless, heat and corrosion resistant
- PP material is widely used in biomedical, environmental protection and food industries



Y Barbed Connector

Features:

- Plug-in hose connectors for easy and convenient application
- Anti-slip and catch-edge design for no leakage
- Imported raw material, non-toxic, tasteless, heat and corrosion resistant
- PP material is widely used in biomedical, environmental protection and food industries

Unit: mm

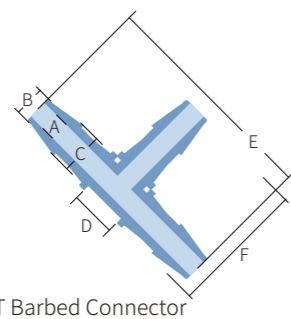
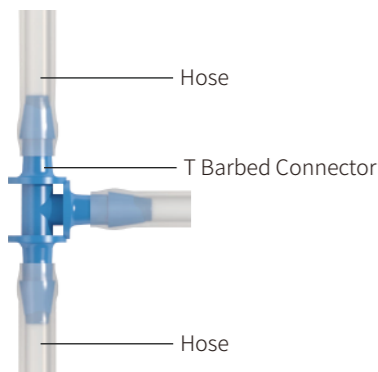

T-T Barbed Connector

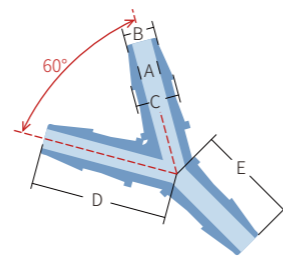

Y-Y Barbed Connector

Model No.	Tubing ID	Dimension (mm)						Material
T Barbed Connector								
T-016	0.8~1.6mm	A=Φ1.08	B=Φ1.82	C=Φ2.45	D=2.2	E=12.8	F=7.73	PP natural
T-020	1.6~2.0 mm	A=Φ1.08	B=Φ2.00	C=Φ3.00	D=3.5	E=17.7	F=10.9	PP natural
T-024	2.0~2.4 mm	A=Φ1.58	B=Φ2.50	C=Φ3.50	D=3.8	E=18.6	F=11.3	PP natural
T-032	2.4~3.2 mm	A=Φ2.36	B=Φ3.30	C=Φ4.80	D=5.2	E=26	F=15.65	PP natural
T-040	3.2~4.0 mm	A=Φ2.96	B=Φ4.00	C=Φ6.00	D=8.8	E=39	F=24.5	PP natural
T-048	4.0~4.8 mm	A=Φ3.94	B=Φ4.80	C=Φ6.80	D=8.8	E=39	F=24.5	PP natural
T-064	4.8~6.4 mm	A=Φ5.42	B=Φ6.40	C=Φ8.70	D=11	E=52.4	F=32.2	PP natural
T-087	6.4~8.7 mm	A=Φ7.78	B=Φ8.70	C=Φ10.70	D=13	E=55	F=34.5	PP natural
Y Barbed Connector								
Y-016	0.8~1.6mm	A=Φ1.18	B=Φ1.82	C=Φ2.45	D=7.12	E=6.15		PP natural
Y-020	1.6~2.0 mm	A=Φ1.08	B=Φ2.00	C=Φ2.80	D=8.00	E=7.00		PP natural
Y-024	2.0~2.4 mm	A=Φ1.58	B=Φ2.50	C=Φ3.50	D=10.98	E=8.04		PP natural
Y-032	2.4~3.2 mm	A=Φ2.36	B=Φ3.30	C=Φ4.80	D=13.80	E=11.30		PP natural
Y-040	3.2~4.0 mm	A=Φ3.00	B=Φ4.06	C=Φ6.09	D=21.21	E=19.18		PP natural
Y-048	4.0~4.8 mm	A=Φ4.00	B=Φ4.87	C=Φ6.90	D=21.30	E=19.30		PP natural
Y-064	4.8~6.4 mm	A=Φ5.50	B=Φ6.45	C=Φ8.48	D=28.93	E=25.88		PP natural
Y-087	6.4~8.7 mm	A=Φ7.50	B=Φ8.63	C=Φ10.86	D=31.68	E=26.30		PP natural



Barbed Bulkhead Union

Features:

- Barbed bulkhead union for hose connection
- Anti-slip and catch-edge design for no leakage
- Imported raw material, non-toxic, tasteless, heat and corrosion resistant.
- PP material is widely used in biomedical, environmental protection and food industries

Application Note

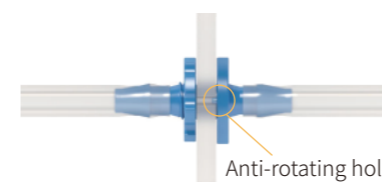

※ Panel thickness ≤ 3mm

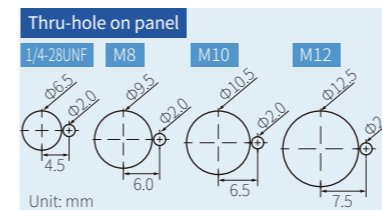

※Nut is also available in PTFE material

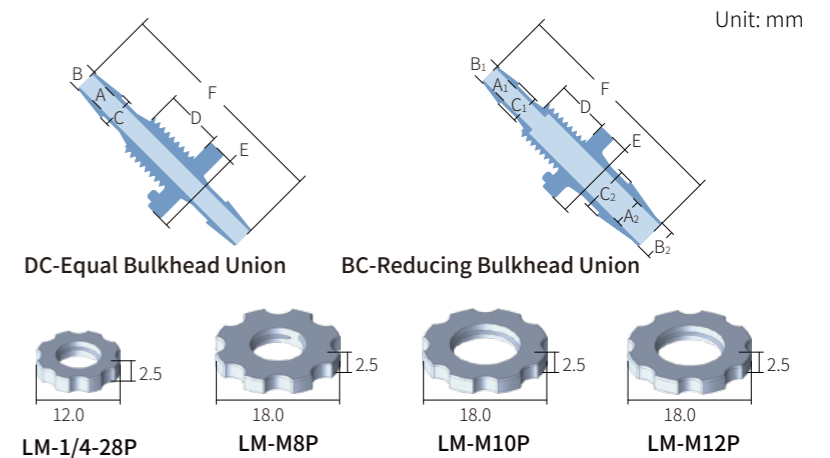

LM-1/4-28P LM-M8P LM-M10P LM-M12P

SKU	Model No.	Thread	Tubing ID	Dimension (mm)			Material
Equal Bulkhead Union							
1008030046	DC-016-1/4-28-016P * LM-1/4-28P	1/4-28UNF	1.0-1.6 mm	A=Φ0.99	B=Φ1.60	C=Φ2.80	D=7.6 E=12 F=27.7 PP natural
1008030047	DC-024-1/4-28-024P * LM-1/4-28P	1/4-28UNF	1.6-2.4 mm	A=Φ1.58	B=Φ2.40	C=Φ3.40	D=7.7 E=12 F=27.7 PP natural
1008030048	DC-032-1/4-28-032P * LM-1/4-28P	1/4-28UNF	2.4-3.2 mm	A=Φ2.46	B=Φ3.20	C=Φ4.20	D=7.7 E=12 F=29.7 PP natural
1008030049	DC-040-M8-040P * LM-M8P	M8	3.2-4.0 mm	A=Φ2.46	B=Φ4.00	C=Φ6.00	D=8.0 E=18 F=36.51 PP natural
1008030050	DC-048-M8-048P * LM-M8P	M8	4.0-4.8 mm	A=Φ3.94	B=Φ4.80	C=Φ6.80	D=8.0 E=18 F=37.3 PP natural
1008030051	DC-064-M10-064P * LM-M10P	M10	4.8-6.4 mm	A=Φ5.42	B=Φ6.40	C=Φ8.40	D=8.0 E=18 F=48.7 PP natural
1008030061	DC-087-M12-087P * LM-M12P	M12	6.4-8.7 mm	A=Φ7.39	B=Φ8.70	C=Φ10.70	D=8.0 E=18 F=49.7 PP natural
Reducing Bulkhead Union							
1008030052	BC-016-1/4-28-024P * LM-1/4-28P	1/4-28UNF	1.0-1.6 mm 1.6-2.4 mm	A ₁ =Φ0.99 A ₂ =Φ1.58	B ₁ =Φ1.60 B ₂ =Φ2.40	C ₁ =Φ2.80 C ₂ =Φ3.40	D=7.7 E=12 F=27.7 PP natural
1008030053	BC-016-1/4-28-032P * LM-1/4-28P	1/4-28UNF	1.0-1.6 mm 2.4-3.2 mm	A ₁ =Φ0.99 A ₂ =Φ2.46	B ₁ =Φ1.60 B ₂ =Φ3.20	C ₁ =Φ2.80 C ₂ =Φ4.20	D=7.6 E=12 F=27.7 PP natural
1008030054	BC-024-1/4-28-032P * LM-1/4-28P	1/4-28UNF	1.6-2.4 mm 2.4-3.2 mm	A ₁ =Φ1.58 A ₂ =Φ2.46	B ₁ =Φ2.40 B ₂ =Φ3.20	C ₁ =Φ3.40 C ₂ =Φ4.20	D=7.6 E=12 F=28.5 PP natural
1008030056	BC-024-1/4-28-048P * LM-1/4-28P	1/4-28UNF	1.6-2.4 mm 4.0-4.8 mm	A ₁ =Φ1.58 A ₂ =Φ3.94	B ₁ =Φ2.40 B ₂ =Φ4.80	C ₁ =Φ3.40 C ₂ =Φ6.80	D=7.7 E=12 F=32.4 PP natural
1008030055	BC-032-1/4-28-048P * LM-1/4-28P	1/4-28UNF	2.4-3.2 mm 4.0-4.8 mm	A ₁ =Φ2.46 A ₂ =Φ3.94	B ₁ =Φ3.20 B ₂ =Φ4.80	C ₁ =Φ4.20 C ₂ =Φ6.80	D=7.7 E=12 F=32.4 PP natural
1008030057	BC-032-1/4-28-064P * LM-1/4-28P	1/4-28UNF	2.4-3.2 mm 4.8-6.4 mm	A ₁ =Φ2.46 A ₂ =Φ5.42	B ₁ =Φ3.20 B ₂ =Φ6.40	C ₁ =Φ4.20 C ₂ =Φ8.40	D=7.7 E=12 F=33.5 PP natural
1008030058	BC-048-M8-064P * LM-M8P	M8	3.2-4.8 mm 4.8-6.4 mm	A ₁ =Φ3.94 A ₂ =Φ5.42	B ₁ =Φ4.80 B ₂ =Φ6.40	C ₁ =Φ6.80 C ₂ =Φ8.40	D=8.0 E=18 F=39.9 PP natural
1008030059	BC-064-M10-087P * LM-M10P	M10	4.8-6.4 mm 6.4-8.7 mm	A ₁ =Φ5.42 A ₂ =Φ7.93	B ₁ =Φ6.40 B ₂ =Φ8.70	C ₁ =Φ8.40 C ₂ =Φ10.70	D=8.0 E=18 F=49.2 PP natural
1008030060	BC-064-M10-127P * LM-M10P	M10	4.8-6.4 mm 8.7-12.7 mm	A ₁ =Φ4.93 A ₂ =Φ10.34	B ₁ =Φ6.40 B ₂ =Φ12.70	C ₁ =Φ8.40 C ₂ =Φ14.70	D=8.0 E=18 F=48.5 PP natural
1008030062	BC-087-M12-127P * LM-M12P	M12	6.4-8.7 mm 8.7-12.7 mm	A ₁ =Φ7.39 A ₂ =Φ10.34	B ₁ =Φ8.70 B ₂ =Φ12.70	C ₁ =Φ10.70 C ₂ =Φ14.70	D=8.0 E=18 F=52.7 PP natural

Barbed Sink Head



Features:

- Sink the hose. Commonly used to connect the external tube of the peristaltic pump to prevent the tubing from twisting, floating and the liquid splashing
- Plug-in type, simple & convenient to use. Anti-slip and catch-edge design for no leakage
- SUS304 stainless steel material, safe and hygienic, featured with high strength, excellent heat resistance, anti-corrosion and no magnetic

Application Note

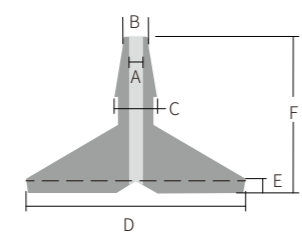
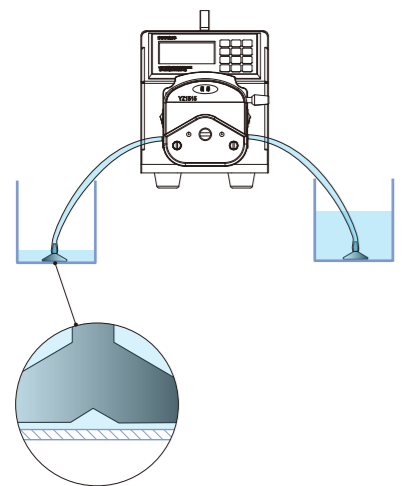

Unit: mm

The bottom of the barbed sink head is designed with a 120° groove, which enables the liquid to flow out stably in time while maintaining its own stability.

Model No.	Tubing ID	Dimension (mm)						Material
Barbed Sink Head								
CT-016	1.0~1.6 mm	A=Φ0.99	B=Φ1.60	C=Φ2.80	D=Φ15	E=1	F=10.7	SUS304
CT-024	1.6~2.4 mm	A=Φ1.58	B=Φ2.40	C=Φ3.40	D=Φ25	E=2	F=14	SUS304
CT-032	2.4~3.2 mm	A=Φ1.97	B=Φ3.20	C=Φ4.20	D=Φ25.7	E=2.5	F=15.2	SUS304
CT-040	3.2~4.0 mm	A=Φ2.96	B=Φ4.00	C=Φ6.00	D=Φ27.3	E=3	F=20	SUS304
CT-048	4.0~4.8 mm	A=Φ3.45	B=Φ4.80	C=Φ6.80	D=Φ35.6	E=3.5	F=23	SUS304
CT-064	4.8~6.4 mm	A=Φ4.93	B=Φ6.40	C=Φ8.40	D=Φ40.7	E=4	F=25.8	SUS304
CT-087	6.4~8.7 mm	A=Φ6.40	B=Φ8.70	C=Φ10.70	D=Φ45.2	E=5	F=27	SUS304

Barbed Check Valve

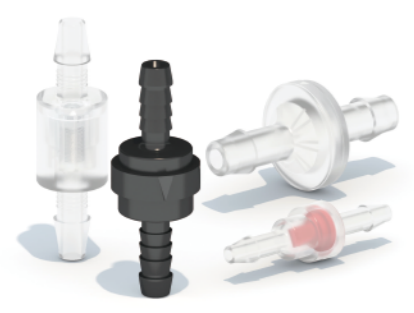

Features:

- Coned check valve, spring check valve and diaphragm check valve for your choice
- Ultrasonic welding, simple structure:
- Plug-in hose connectors for easy and convenient application. Anti-slip and catch-edge design for no leakage
- Imported raw material, widely used in biomedical, environmental protection and food industries, multiple materials are also available for the chemical industry and other applications

Tips

Diaphragm check valve



Unlock pressure > 2kPa
Back pressure < 300kPa

Coned check valve

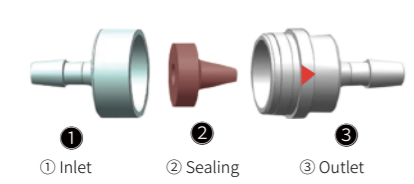

Unlock pressure > 2kPa
Back pressure < 300kPa

Spring check valve

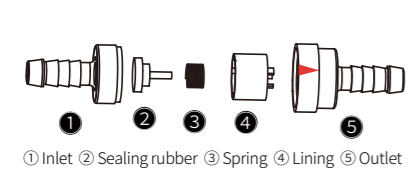
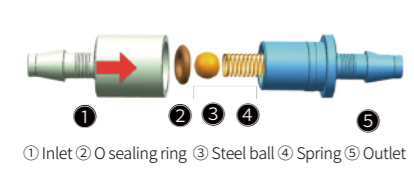

Unlock pressure > 5kPa
Back pressure < 300kPa

Note: Unlock pressure vary from the elasticity of spring

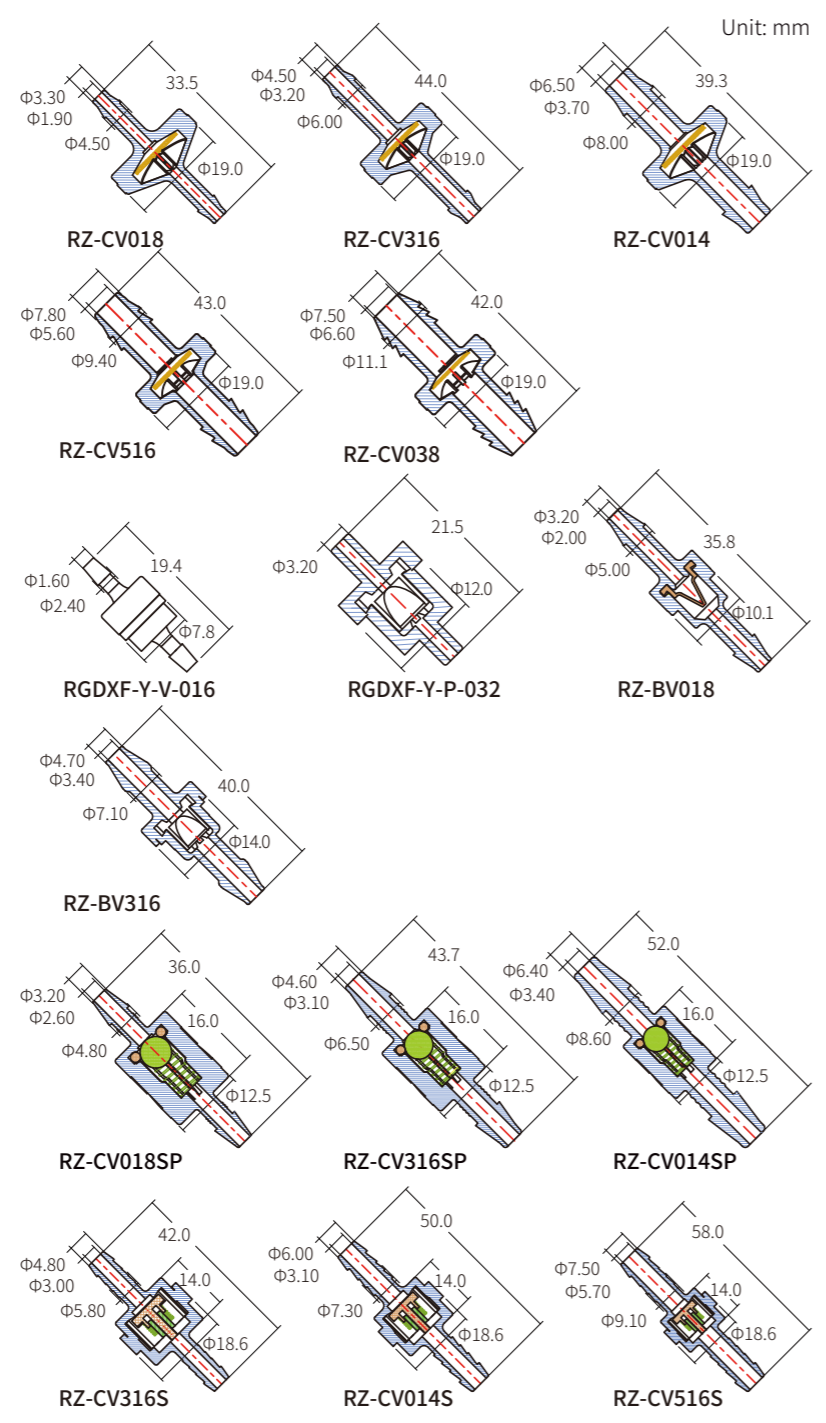

Model No.	Barbed End	Tubing ID	Diaphragm Material	Valve Material	
Diaphragm check valve					
RZ-CV018PAF	1/8	2.5~4.0 mm	Viton	Nylon(two color)	
RZ-CV018ABS	1/8	2.5~4.0 mm	Silicone	ABS(two color)	
RZ-CV018PPF	1/8	2.5~4.0 mm	Viton	PP	
RZ-CV018PPE	1/8	2.5~4.0 mm	EPDM	PP	
RZ-CV018PDF	1/8	2.5~4.0 mm	Viton	PVDF	
RZ-CV018PCF	1/8	2.5~4.0 mm	Viton	PC(transparent)	
RZ-CV316PAF	3/16	4.0~5.5 mm	Viton	Nylon(two color)	
RZ-CV316ABS	3/16	4.0~5.5 mm	Silicone	ABS(two color)	
RZ-CV316PPF	3/16	4.0~5.5 mm	Viton	PP	
RZ-CV316PDF	3/16	4.0~5.5 mm	Viton	PVDF	
RZ-CV316PCF	3/16	4.0~5.5 mm	Viton	PC(transparent)	
RZ-CV014PAF	1/4	6.0~7.5 mm	Viton	Nylon(two color)	
RZ-CV014ABS	1/4	6.0~7.5 mm	Silicone	ABS	
RZ-CV014PPF	1/4	6.0~7.5 mm	Viton	PP	
RZ-CV014PDF	1/4	6.0~7.5 mm	Viton	PVDF	
RZ-CV014PCF	1/4	6.0~7.5 mm	Viton	PC(transparent)	
RZ-CV516PAF	5/16	7.0~9.0 mm	Viton	Nylon(two color)	
RZ-CV516ABS	5/16	7.0~9.0 mm	Silicone	ABS(two color)	
RZ-CV516PPF	5/16	7.0~9.0 mm	Viton	PP	
RZ-CV516PDF	5/16	7.0~9.0 mm	Viton	PVDF	
RZ-CV516PCF	5/16	7.0~9.0 mm	Viton	PC(transparent)	
RZ-CV038PAF	3/8	8.5~10.5 mm	Viton	Nylon(two color)	
RZ-CV038ABS	3/8	8.5~10.5 mm	Silicone	ABS(two color)	
RZ-CV038PPF	3/8	8.5~10.5 mm	Viton	PP	
RZ-CV038PDF	3/8	8.5~10.5 mm	Viton	PVDF	
RZ-CV038PCF	3/8	8.5~10.5 mm	Viton	PC(transparent)	
Coned check valve					
Model No.	Barbed End	Tubing ID	Sealing Material	Valve Material	
RZ-BV116PDE	1/16	1.0~1.6 mm	EPDM	PVDF	
RZ-BV116PPS	1/16	1.0~1.6 mm	Silicone	PP	
RGDXF-Y-P-032	1/8	1.6~2.4 mm	Viton Silicone	PP	
RZ-BV018PPF	1/8	2.5~4.0 mm	Viton	PP	
RZ-BV018PPS	1/8	2.5~4.0 mm	Silicone	PP	
RZ-BV316PPFVMQ	3/16	4.5~6.0 mm	Viton Silicone	PP	
RZ-BV316PDFVMQ	3/16	4.5~6.0 mm	Viton Silicone	PVDF	
Spring check valve					
Model No.	Barbed End	Tubing ID	Valve Material	Diaphragm Material	Valve Material
RZ-CV018SPPOF	1/8	2.5~4.0 mm	SUS316L	Viton	PP
RZ-CV018SPDOF	1/8	2.5~4.0 mm	SUS316L	Viton	PVDF
RZ-CV316SPPOF	3/16	4.5~6.0 mm	SUS316L	Viton	PP
RZ-CV316SPDOF	3/16	4.5~6.0 mm	SUS316L	Viton	PVDF
RZ-CV014SPPOF	1/4	6.0~7.5 mm	SUS316L	Viton	PP
RZ-CV014SPDOF	1/4	6.0~7.5 mm	SUS316L	Viton	PVDF
RZ-CV316SPAF	3/16	4.5~5.5 mm	SUS316L	Viton	nylon
RZ-CV014SPAF	1/4	6.0~7.0 mm	SUS316L	Viton	nylon
RZ-CV516SPAF	5/16	7.0~8.5 mm	SUS316L	Viton	nylon